

MYPro series MYTower™ storage system

Specifications
November 2021



Specifications MYPro series **MYTower™**

CAPABILITY	
STORAGE SYSTEM FOR SMD REELS	
Reel sizes	4-32mm (4"/100mm reels)
	4-32mm (7"/180mm reels)
	4-56mm (13"/300mm reels)
	4-56mm (15"/380mm reels)
Freely configurable and expandable	
Access time	5 reels/minute

CAPACITY		
MAXIMUM REELS		
Tower model	Reel size	Number of reels
MYTower 5	4mm/4-7"	812
MYTower 6	4mm/4-7"	980
MYTower 6+	4mm/4-7"	980
MYTower 7+	4mm/4-7"	1,148
MYTower 5x	4mm/4-7"	2,052
MYTower 6x	4mm/4-7"	2,468

CASSETTES			
CASSETTES AVAILABLE			
Reel width	4-7" Reel diameter	13" Reel diameter	15" Reel diameter
4mm	• ⁽¹⁾	• ⁽¹⁾	• ⁽¹⁾
8mm	•	•	•
12mm	•	•	•
16mm	•	•	•
24mm	•	•	•
32mm	•	•	•
44mm		•	•
56mm		•	•

(1) Only available in MYTower 5x and 6x

SOFTWARE		
SOFTWARE FUNCTIONS	Standard mode	MYCenter oode
Component management	•	• ⁽¹⁾
Stock monitoring	•	• ⁽¹⁾
External communication protocol	•	•
User access system	•	•
Traceability	•	•
Job preparation	•	• ⁽¹⁾
Barcoding	•	• ⁽¹⁾
Data import/export function	•	• ⁽¹⁾
Inventory function	•	• ⁽¹⁾
Component allocation	•	

(1) Handled by MYCenter software

ACCESSORY	
DRY AIR UNIT FREY FND 3.0 F-DP	
Flow rate, max	(in) 24m ³ /h, (out) 20m ³ /h
Flow rate, type	3m ³ /h
Air supply	Class 4 (ISO 8573-1) or better
Operating pressure	5-10bar
Power supply	115/230V, 50/60hz, 18W
Dimension (WxDxH)	330mm x 270mm x 840mm (13.0" x 10.6" x 33.1")

DRY AIR UNIT DST DC-20/30 T10/T16	
Weight	32kg
Power supply	115/230V, 50/60hz
Dimension (WxDxH)	435mm x 243mm x 663mm

MYTower 5

The MYTower 5 is Mycronic's most compact component storage system. Perfectly suited for customers with limited floor space and height restrictions in their factory. The MYTower 5 has a maximum capacity of 812 reels, and is easily configurable to store 4-15" reels.



CONFIGURATION

STANDARD CONFIGURATION

Reel size	Number of reels	Total
8mm/4-7"	56	354
8mm/13"	56	
8mm/15"	0	
12mm/4-7"	48	
12mm/13"	36	
12mm/15"	24	
16mm/4-7"	20	
16mm/13"	30	
16mm/15"	10	
24mm/4-7"	0	
24mm/13"	16	
24mm/15"	16	
32mm/4-7"	0	
32mm/13"	14	
32mm/15"	14	
44mm/13"	5	
44mm/15"	5	
56mm/13"	0	
56mm/15"	4	

MISCELLANEOUS

INSTALLATION REQUIREMENTS

Weight	270kg/600 lbs
Power requirements	Single phase AC 300VA
Voltage	115/230V, 50/60hz
Ambient temperature	18-35°C (65-95°F), < 95% RH non condensing

DIMENSIONS

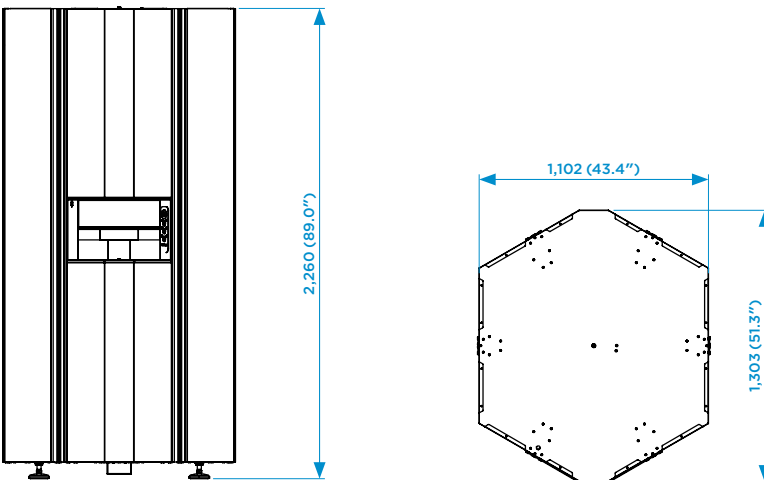

MYTower 6

The MYTower 6 has a capacity of 980 reels, suited for storing large quantity of 4-13" reels as well as 15" reels. Coming in at under 1.5m² this component storage system has the same footprint as the MYTower 5, but has one extra row of cassettes enabling a higher capacity.



CONFIGURATION

STANDARD CONFIGURATION

Reel size	Number of reels	Total
8mm/4-7"	56	418
8mm/13"	70	
8mm/15"	0	
12mm/4-7"	48	
12mm/13"	36	
12mm/15"	24	
16mm/4-7"	40	
16mm/13"	30	
16mm/15"	10	
24mm/4-7"	0	
24mm/13"	24	
24mm/15"	24	
32mm/4-7"	0	
32mm/13"	21	
32mm/15"	21	
44mm/13"	5	
44mm/15"	5	
56mm/13"	0	
56mm/15"	4	

MISCELLANEOUS

INSTALLATION REQUIREMENTS

Weight	340kg/750 lbs
Power requirements	Single phase AC 300VA
Voltage	115/230V, 50/60hz
Ambient temperature	18-35°C (65-95°F), <95% RH non condensing

DIMENSIONS

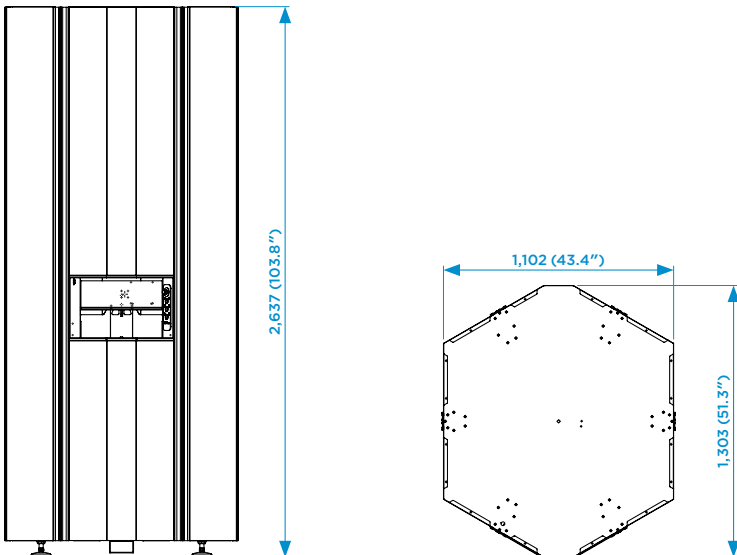

MYTower 6+

The MYTower 6+ is the same height as the MYTower 6, with the key difference being the ability to store 15" reels in all magazines within the storage system. This model has a maximum capacity of 980 reels whilst giving the customer flexibility to store any size of reel.



CONFIGURATION

STANDARD CONFIGURATION

Reel size	Number of reels	Total
8mm/4-7"	0	287
8mm/15"	0	
12mm/4-7"	0	
12mm/15"	72	
16mm/4-7"	0	
16mm/15"	80	
24mm/4-7"	0	
24mm/15"	56	
32mm/4-7"	0	
32mm/15"	42	
44mm/15"	25	
56mm/15"	12	

MISCELLANEOUS

INSTALLATION REQUIREMENTS

Weight	360kg/794 lbs
Power requirements	Single phase AC 300VA
Voltage	115/230V, 50/60 hz
Ambient temperature	18-35°C (65-95°F), <95% RH non condensing

DIMENSIONS

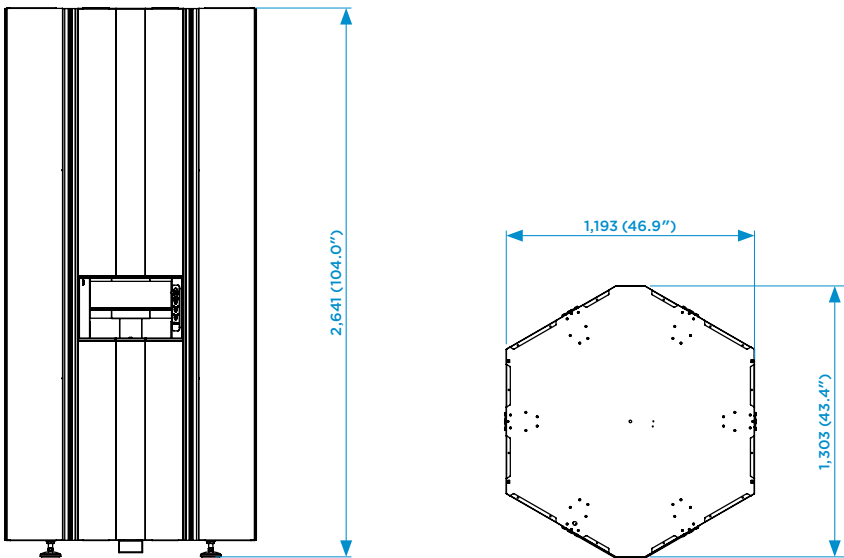

MYTower 7+

The MYTower 7+ is Mycronic's tallest component storage system, measuring at 3.03m, with a capacity of 1,148 reels. This component storage system has a footprint of 1.55m², and is designed to store the large quantities of reels right next to your SMT lines.



CONFIGURATION

STANDARD CONFIGURATION

Reel size	Number of reels	Total
8mm/4-7"	392	663
8mm/15"	28	
12mm/4-7"	48	
12mm/15"	48	
16mm/4-7"	20	
16mm/15"	40	
24mm/4-7"	0	
24mm/15"	32	
32mm/4-7"	0	
32mm/15"	28	
44mm/15"	15	
56mm/15"	12	

MISCELLANEOUS

INSTALLATION REQUIREMENTS

Weight	580kg/1,279lbs
Power requirements	Single phase AC 300VA
Voltage	115/230V, 50/60hz
Ambient temperature	18-35°C (65-95°F), <95% RH non condensing

DIMENSIONS

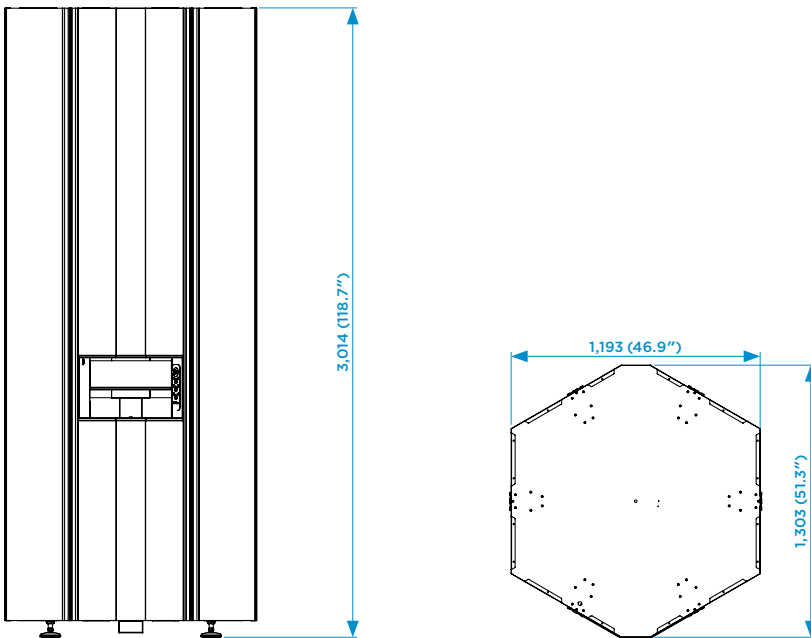

MYTower 5x

The MYTower 5x is perfect for customers with height restrictions, looking to store as many reels as possible, whilst utilizing as little floorspace as possible. Perfect for storing large quantities of 7" reels, with a maximum capacity of 2,052 reels in a footprint less than 2m². Can be used both as a main warehouse or as buffer storage close to your production line.



CONFIGURATION

STANDARD CONFIGURATION

Reel size	Number of reels	Total
8mm/4-7"	280	1,109
8mm/15"	28	
12mm/4-7"	240	
12mm/15"	36	
16mm/4-7"	200	
16mm/15"	0	
24mm/4-7"	160	
24mm/15"	16	
32mm/4-7"	140	
32mm/15"	0	
44mm/15"	5	
56mm/15"	4	

MISCELLANEOUS

INSTALLATION REQUIREMENTS

Weight	650kg/1,433lbs
Power requirements	Single phase AC 500VA
Voltage	115/230V, 50/60hz
Ambient temperature	18-35°C (65-95°F), <95% RH non condensing

DIMENSIONS

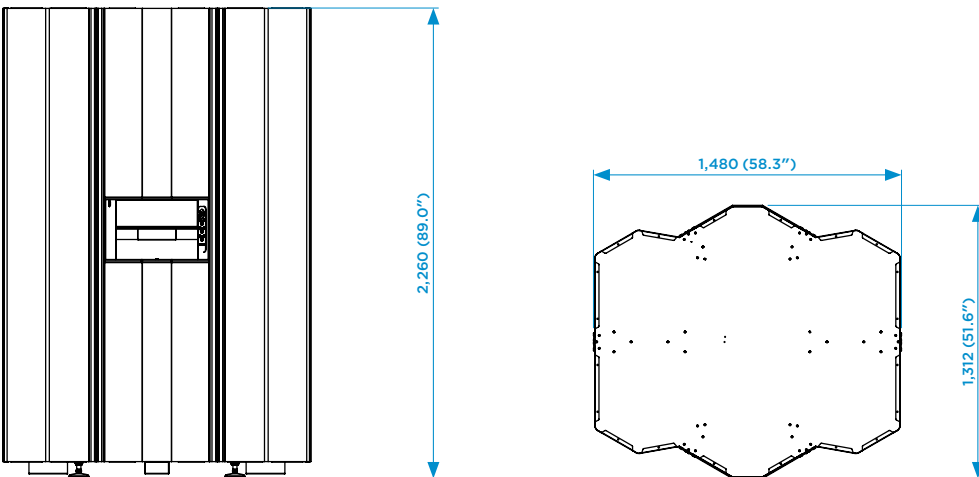

MYTower 6x

Mycronic's largest component storage system capable of storing 2,468 reels in less than 2m². This component storage system is the same height as the MYTower 6 and MYTower 6+, but with a new storage technology, is able to store large quantities of reels. Can be used both as a main warehouse or as buffer storage close to your production line.



CONFIGURATION

STANDARD CONFIGURATION

Reel size	Number of reels	Total
8mm/4-7"	280	1,371
8mm/15"	28	
12mm/4-7"	480	
12mm/15"	48	
16mm/4-7"	200	
16mm/15"	10	
24mm/4-7"	160	
24mm/15"	16	
32mm/4-7"	140	
32mm/15"	0	
44mm/15"	5	
56mm/15"	4	

MISCELLANEOUS

INSTALLATION REQUIREMENTS

Weight	750kg/1653 lbs
Power requirements	Single phase AC 500VA
Voltage	115/230V, 50/60hz
Ambient temperature	18-35°C (65-95°F), <95% RH non condensing

DIMENSIONS

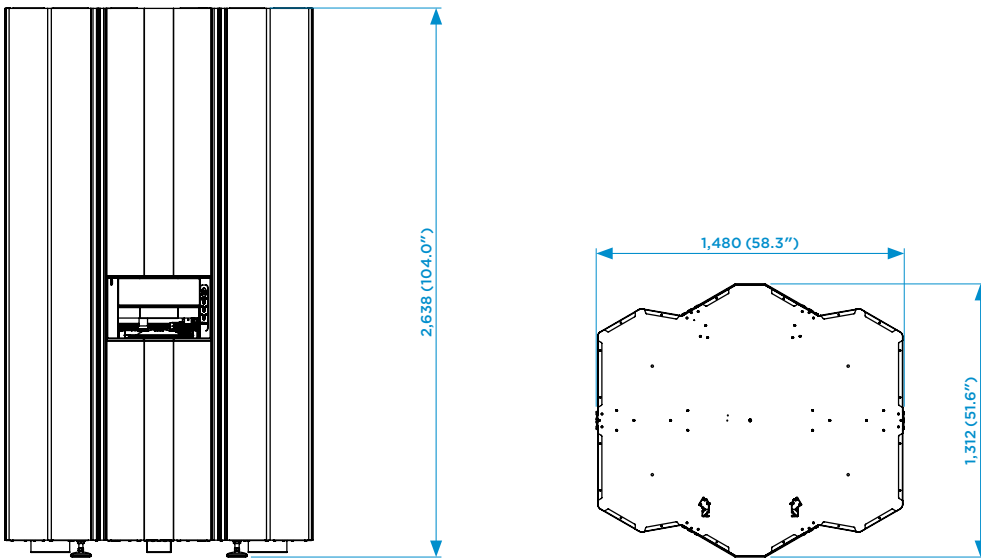

SWEDEN

Mycronic AB
PO Box 3141
Nytorpsvägen 9
SE-183 03 Täby
Sweden

Tel: +46 8 638 52 00

NETHERLANDS

Mycronic B.V.
High Tech Campus 10
5656 AE
Eindhoven
Netherlands

Tel: +31 402 62 06 67

FRANCE

Mycronic S.A.S.
1 rue de Traversière
CS 80045
94513 Rungis Cedex 1
France

Tel: +33 1 41 80 15 80

SOUTH KOREA

Mycronic Co. Ltd.
3rd Floor, Jung-San Bldg.
163 LS-ro Gunpo-Si
Gyonggi-Do, 15808
South Korea

Tel: +82 31 387 5111

SINGAPORE

Mycronic Pte., Ltd.
9 Tagore Lane,
#02-08/09
9@Tagore
Singapore 787472

Tel: +65 6281 7997

GERMANY

Mycronic GmbH
Biberger Straße 93
D-82008 Unterhaching
bei München
Germany

Tel: +49 89 4524248-0

UK

Mycronic Ltd.
Unit 2, Concept Park
Innovation Close
Poole, Dorset, BH12 4QT
UK

Tel: +44 1202 723 585

CHINA

Mycronic Co., Ltd.
Unit 106, E Block
Lane 168, Da Duhe Road.
Putuo District, 200062
Shanghai P.R. China

Tel: +86 21 3252 3785/86

JAPAN

Mycronic Technologies KK
KDX Chofu Bldg.7th floor
1-18-1 Chofugaoka,
Chofu-shi
Tokyo 182-0021
Japan

Tel: +81 42 433 9400

USA

Mycronic Inc.
554 Clark Road
Tewksbury
MA 01C876-1731
USA

Tel: +1 978 495 9799